



HOLMANS
ESTATE AGENTS

20 The Grange, Moreton-in-Marsh, Gloucestershire, GL56 0AU

Offers Over £100,000, Leasehold

Property Description

Positioned in a concealed courtyard location just off the High Street in Moreton-in-Marsh and appealing exclusively to those over 55 years of age, this purpose built one bedroomed apartment offers an excellent opportunity for those looking for a retirement apartment and is only a few strides away from one of the most popular tree-lined High Streets in the North Cotswolds.

The five properties within this portion of the development have access to their own lift and in this case to the first floor with two southerly aspected windows creating a light and airy atmosphere. Character of the property is added with cornice moulded ceilings, a fitted fireplace in the living room which also has a box bay window with outlook over communal gardens.

There is a four piece bathroom suite and a well fitted kitchen with a range of integrated appliances, electronically operated sash window and also views over the gardens.

The Grange is positioned to the northern end of the High Street, only a few yards from the Co-Op supermarket and ease of access to the towns railway station with links to Oxford and London Paddington.

The advantage of Moreton-in-Marsh for retirement purposes is that the town is completely flat and incorporates a wide range of shops, tearooms, hostelrys, two doctors surgeries and a community hospital.

For those therefore looking for a compact retirement retreat, yet close to all amenities in the town and at an affordable price, look no further.

Accommodation comprises:

Communal Entrance Hall

Electronically operated lift ascending to the two floors above with separate staircase.

First Floor Landing

Night store heater. Access to staircase and lift.

Entrance Hall

(24' 5" x 7' 3" Max) or (7.44m x 2.21m Max)

Night store heater. Cornice moulded ceiling, highlighted dado rail. Two sash windows with southerly aspect over treescape. Built-in bookshelf and cupboard unit. Intercom system to front door. Access to bathroom. Airing cupboard with built-in OSO pressurised hot water system.

Front Bedroom

(9' 5" x 13' 7") or (2.86m x 4.13m)

Two double built-in wardrobes. Attractive northerly aspect over communal grounds. Night store heater. Access to bathroom.

Bathroom (Jack and Jill)

(14' 4" x 5' 5") or (4.36m x 1.66m)

Four piece coloured suite pedestal wash hand basin, low flush WC and bidet. Handled panel bath with Mermaid mobility lift. Two built-in extractors. Part tiled walls. Two electric panelled radiators.

Kitchen

(10' 1" x 9' 5") or (3.08m x 2.86m)

Fitted on three sides with woodgrain effect laminate worktops. Inset 1 1/2 asterite sink unit with single drainer and mixer tap. Seven base units, four matching wall-mounted units. Slot-in Bosch washing machine. Split-level integrated Bosch microwave with Bosch electric circatherm below. Split-level IceKing fridge with built-in freezer below. Four ring electric hob with peninsular Neff cooker hood above. Wall-mounted Dimplex electric heater. Mosaic tiled surround to work surfaces with some concealed pelmet lighting. Particularly attractive outlook over communal grounds. Built-in extractor and electronically operated sash window.

Through Living Room

(20' 6" x 10' 9") or (6.24m x 3.27m)

Square bay window with outlook over landscaped communal gardens and over treescape to the rear. Two night store heaters. Moulded fireplace surround with composite marble hearth and electric flicker flame fire. Wall-mounted feature light. Built-in single wardrobe. Ample room for dining table.

Parking

The property has its own reserved parking space within the central block paved area in front of a double fronted bungalow.

Tenure and Service Charge

The property is held under a 99 year lease from when the property was constructed in 1990, there are therefore 65 years remaining on the current lease. There is an annual service charge of approximately £5560.00 per annum and a ground rent of approximately £200.00 per annum. Prospective purchasers are advised to ascertain the exact terms and conditions of the lease in pre-contract enquiries to exchange of contracts. There is a development manager on site who can be contacted from various points within the property. When the development manager is off duty there is a 24 hour emergency call system.



20 The Grange, Moreton in Marsh, GL56 0AU

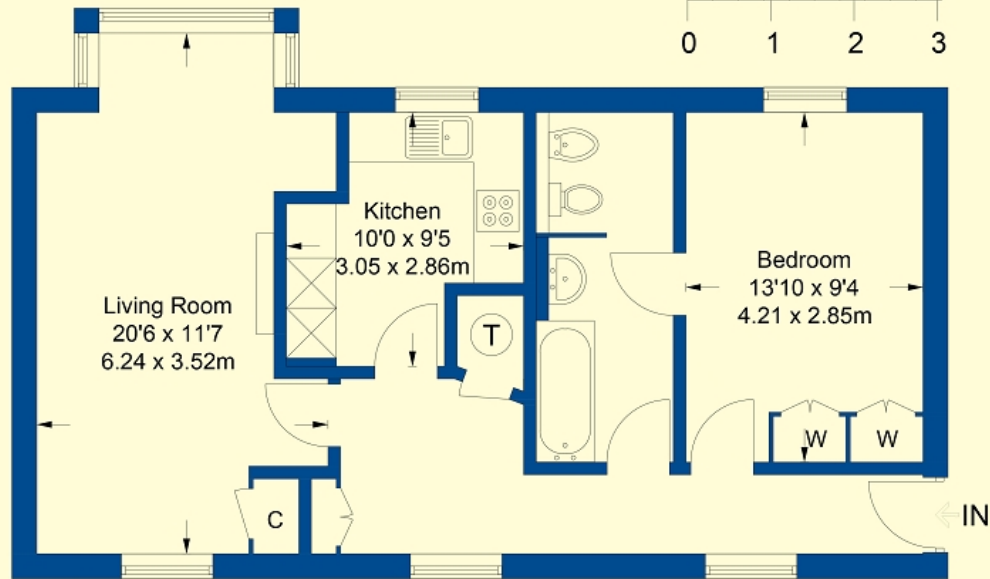
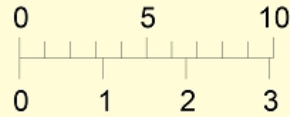

First Floor

Approximate Gross Internal Area = 58.6 sq m / 631 sq ft

Illustration for identification purposes only, measurements are approximate, not to scale. (ID787811)

HOLMANS
ESTATE AGENTS

Directions

From our Moreton-in-Marsh office, turn right and at the end of the High Street, just before the Co-Op supermarket, turn right in to The Grange. If driving turn immediately left where there are several visitor spaces. Continue to the centre of the development, past the managers office and through the communal gardens. the entrance to this property is then located in the furthest corner next to Number 22 and the lift will then give you access to the first floor.

rightmove

onTheMarket.com



MISDESCRIPTIONS CLAUSE We would like to inform prospective purchasers that Holmans Estate Agents have not tested any included apparatus, equipment, fixtures, fittings, central heating systems or services mentioned in these particulars, and purchasers are advised to satisfy themselves as to their working order and condition. These particulars do not constitute, nor constitute any part of, an offer or contract. All statements contained in these particulars as to this property are made without responsibility on the part of Holmans Estate Agents or the vendors or lessors. Any intending purchaser must satisfy themselves by inspection or otherwise as to the correctness of each of the statements contained in these particulars. The vendors do not make or give, and neither Holmans Estate Agents nor any person in their employment has any authority to make or give any representation or warranty whatever in relation to this property.

HOLMANS
ESTATE AGENTS